



101 S. 1ST AVENUE
ARCADIA, CA 91106

SIZE:

4,000 SQFT

PRICE

\$2.65/FT NNN

AVAILABLE

NOW

PROPERTY HIGHLIGHTS:

- Restaurant infrastructure in place with a newly renovated open floor plan.
- New two inch water line, 15 tons of HVAC, 600 amp panel, and Conditional Use Permit for beer & wine
- Display windows surround building for great street visibility to attract heavy foot traffic
- City of Arcadia easy to comply with.
- Close to Santa Anita Race Track and Westfield Santa Anita Mall.
- Located in the heart of Downtown Arcadia. Walking distance to the Metro Gold Line.



Hoss MacVaugh

Office: 626.583.8400 • **Cell:** 626.255.2308 • **Email:** hoss@macvaugh.com

MacVaugh & Co. • 87 North Raymond Ave. Suite 320 • Pasadena • CA 91103 • www.MacVaugh.com

The information contained herein has been obtained from sources deemed to be reliable. While we have no reason to doubt its accuracy, we do not guarantee to and assume no liability for any inaccuracies and/or omissions. This is not an offering.

Terms and conditions are subject to change. BRE License #00971669

FLOOR PLAN

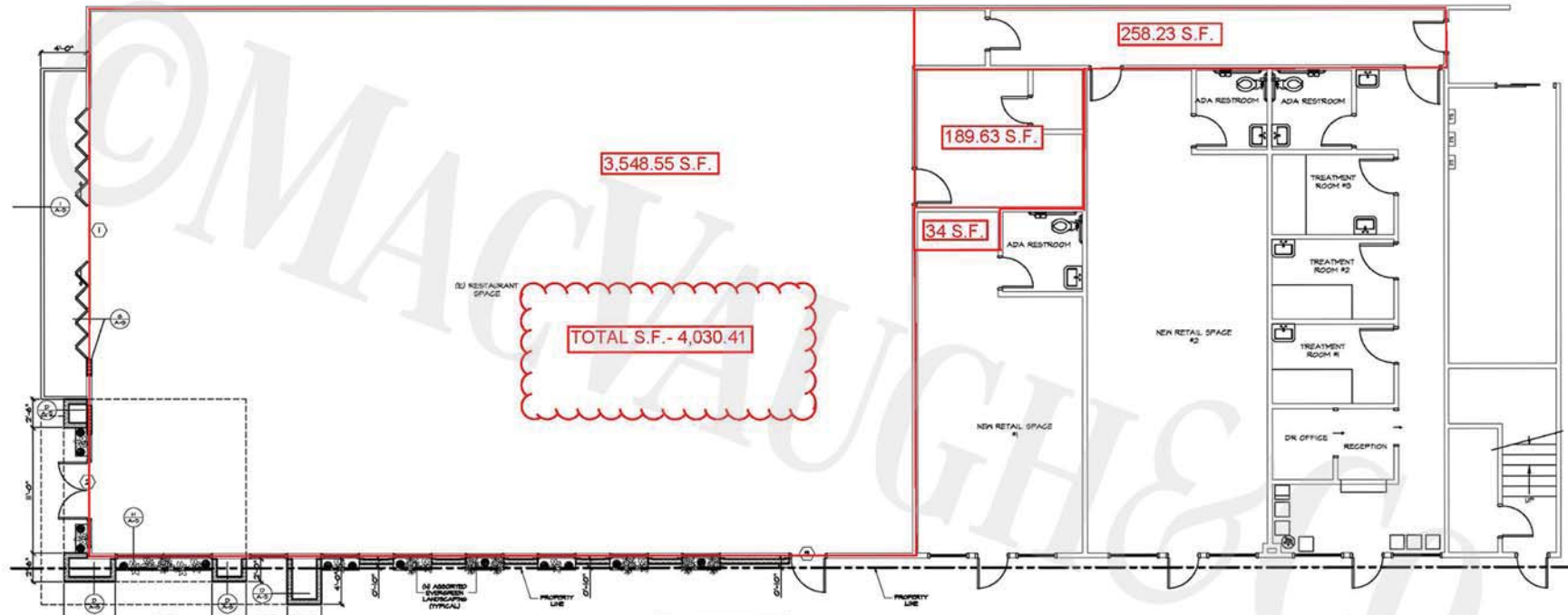

WALL SCHEDULE

- EXISTING 2X 8 STD WALL
- NEW 2X 8 STD WALL
- - - EXIST. 2X 8 STD WALL TO BE REMOVED
- 1 HOUR RATED WALL 2x8" STUD, BOARD, TYPE "F" FLOOR TO ROOF

MARK	LOCATION	TYPE	SIZE (ORIGINAL)	TRK	DOOR	FRAME	FINISH	REMARKS
1	FRONT RESTAURANT	A	22'-0" x 8'-6"	3/4"	ALUM.	PAINT	ALUM.	DOOR IS NEW WITH LEVER TYPE HARDWARE
2	RESTAURANT ENTRANCE	A	9'-0" x 8'-6"	3/4"	ALUM.	PAINT	ALUM.	DOOR IS NEW WITH PUSH PULL HARDWARE AND IS SELF-CLOSING
3	RESTAURANT REAR/DRY EXIT	A	8'-0" x 8'-6"	3/4"	ALUM.	PAINT	ALUM.	DOOR IS NEW WITH PUSH PULL HARDWARE AND IS SELF-CLOSING

Legacy BUILDERS
DESIGN & CONSTRUCTION (818) 482-7003

PROJECT TITLE ADDRESS
PROPOSED EXTERIOR FACADE RE-MODEL
101 FIRST ST. # 60 ALTA ST.
ARCADIA, CA. 91006

SCALE
1/4" = 1'-0"

SHEET TITLE
PROPOSED FLOOR PLAN

SHEET NO.
A-2