

# 33 E UNION ST PASADENA CA 91103



**Hoss MacVaugh**

626.583.8400 | Hoss@MacVaugh.com | #00971669

**MACVAUGH & CO**  
Commercial Real Estate Services

# LEASE HIGHLIGHTS

Second-generation restaurant. Currently occupied by a pizza concept. Patio seating is available through the City of Pasadena. Direct neighbors include Union, Pez Cantina and The Blind Donkey. One block from Colorado Blvd.

## SIZE

---

3,188 SQFT

## PRICE

---

\$3.75/SF NNN

## FINISHES

---

Hardwood flooring throughout, brick accent walls, exposed ceilings

## LAYOUT

---

Large dining area, full bar, cool/dry storage, private office & two restrooms

## AVAILABLE

---

October 1, 2024





**Hoss MacVaugh**

626.583.8400

Hoss@MacVaugh.com

#00971669

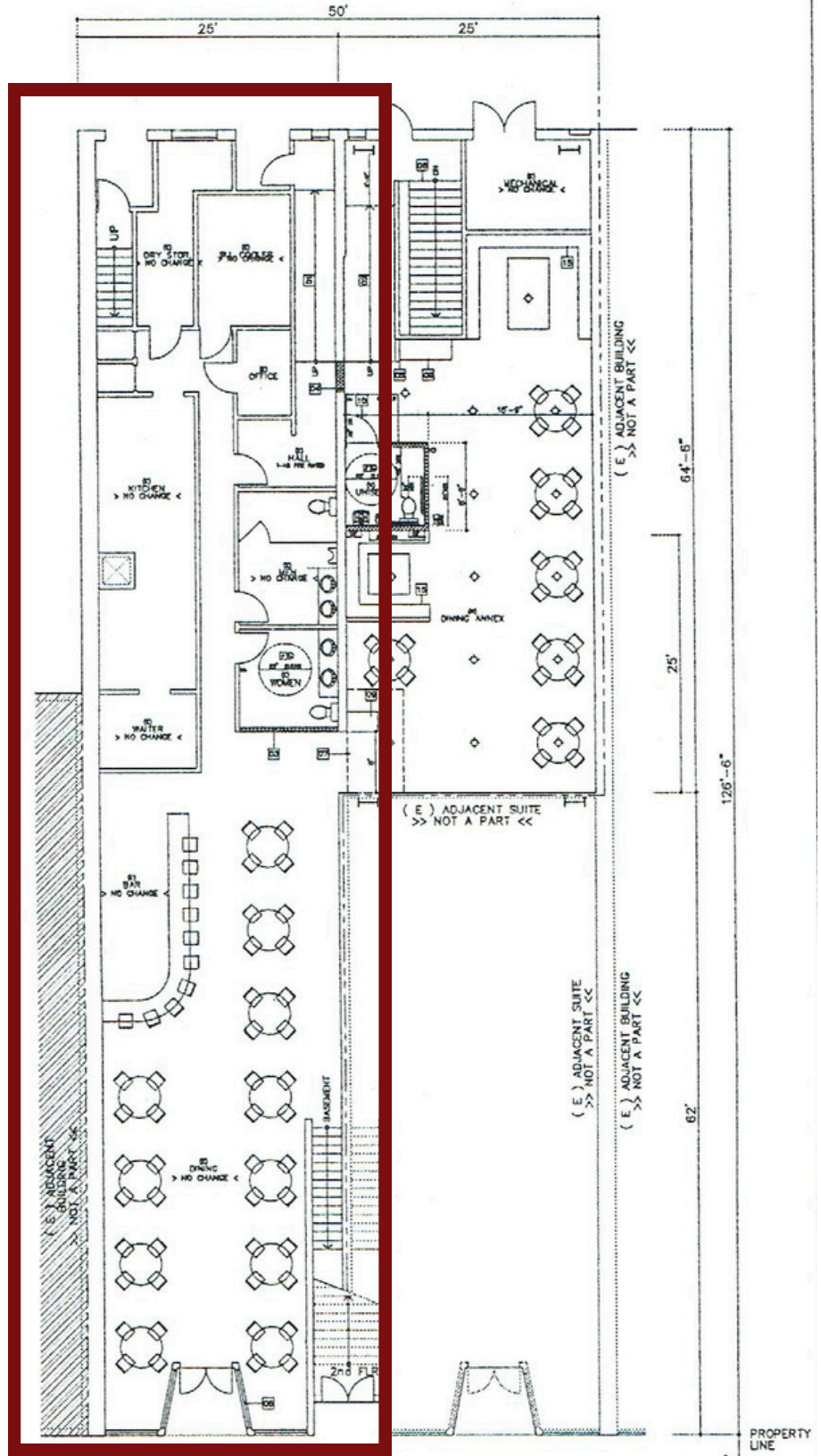

# OLD PASADENA MAP

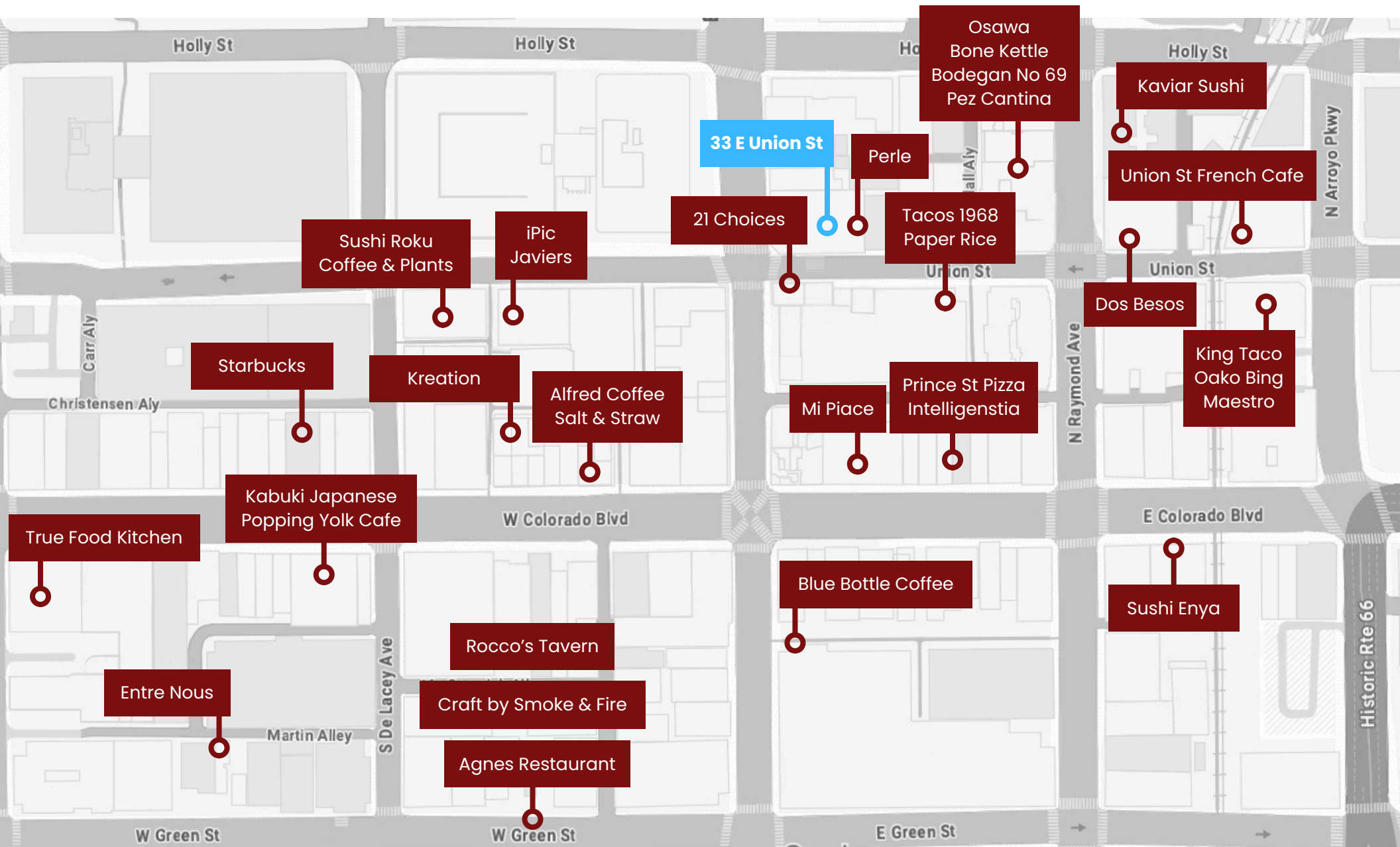

# PASADENA, CA

## CITY INFORMATION

200k population, 110k employees, 127k average household income all within a 3-mile radius

The seasonal population reaches its peak through the Rose Bowl with sports events, concerts and New Years Eve/Day

Ranked as one of the top walking and retail locations in the United States with a walk score of 98 and a bike score of 73

National icons such as Art Center College of Design, JPL and Cal Tech

Multiple Metro Gold Line stops are located throughout the city - Bringing in people from Azusa to Downtown Santa Monica

You'll find a combination of mom-and-pop shops and major tenants keeping the history of the city alive while bringing a modern day flare

Deeply rooted with history, architecture and art with notable neighbors such as the Norton Simon Museum, City Hall and hundreds of historically significant buildings

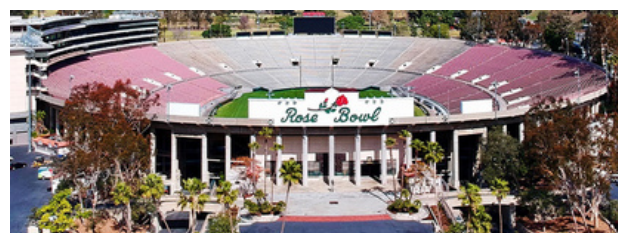

**Hoss MacVaugh**

626.583.8400 | [Hoss@MacVaugh.com](mailto:Hoss@MacVaugh.com) | #00971669